

CHELSEA® 871 SERIES

Hydraulic PowerShift 10-Bolt PTO for Allison 3000/4000 Family Transmissions

Chelsea's 871 Series is a small but mighty, 10-Bolt Power Take-Off. Its compact housing eliminates possible clearance issues and multiple assembly arrangements maximize your installation possibilities. High capacity bearings and superior gear designs provide impressive torque ratings up to 670 ft-lb. There is no need to derate the PTO for continuous duty applications. Chelsea's 871 Series features a ductile iron bearing cap which is 117% stronger than its predecessor, and an o-ring sealing configuration between the housing and bearing cap to improve clamp load. All of these improvements are focused on reducing the damaging vibrational effects caused by today's and future engine designs. Multiple gear ratios provide a wide variety of speeds to meet all of your application requirements.

The 871 Series is a unique PTO in that it is one of the only Chelsea PTOs to offer all three of Chelsea's high-demand solutions: Wet Spline, SmartStart, and Quiet Gear™ options.

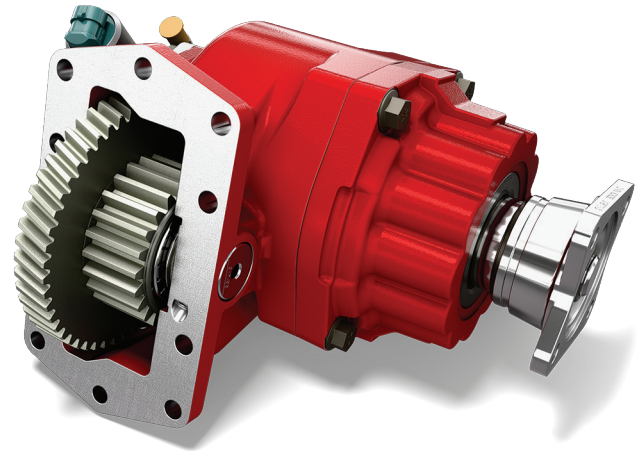

871 Series

Applications:

- Fire and Rescue Trucks
- Truck Cranes
- Pumper Cleaner Trucks
- Refuse Trucks

Product Features and Benefits:

- Ductile Iron bearing cap – 117% stronger than gray iron.
- Improved Seal – O-ring sealing configuration to reduce vibrational effects and improve clamp load.
- Power – Torque capacity up to 670 lb-ft / 908 N-m.
- Compact – Housing height reduces clearance issues.
- Quiet – Quiet Gear™ input option available.
- SmartStart – Option available to reduce shock load at start-up for certain applications.
- Insurance – Electronic Overspeed Control (EOC) protects driven equipment.
- Speeds – Multiple speed ratios including low and high speeds.
- Outputs – Numerous output options.
- Protection – Wet Spline pump flange extends PTO and pump shaft life.



871 Series Power Take-Off – Allison
Model Number Designator

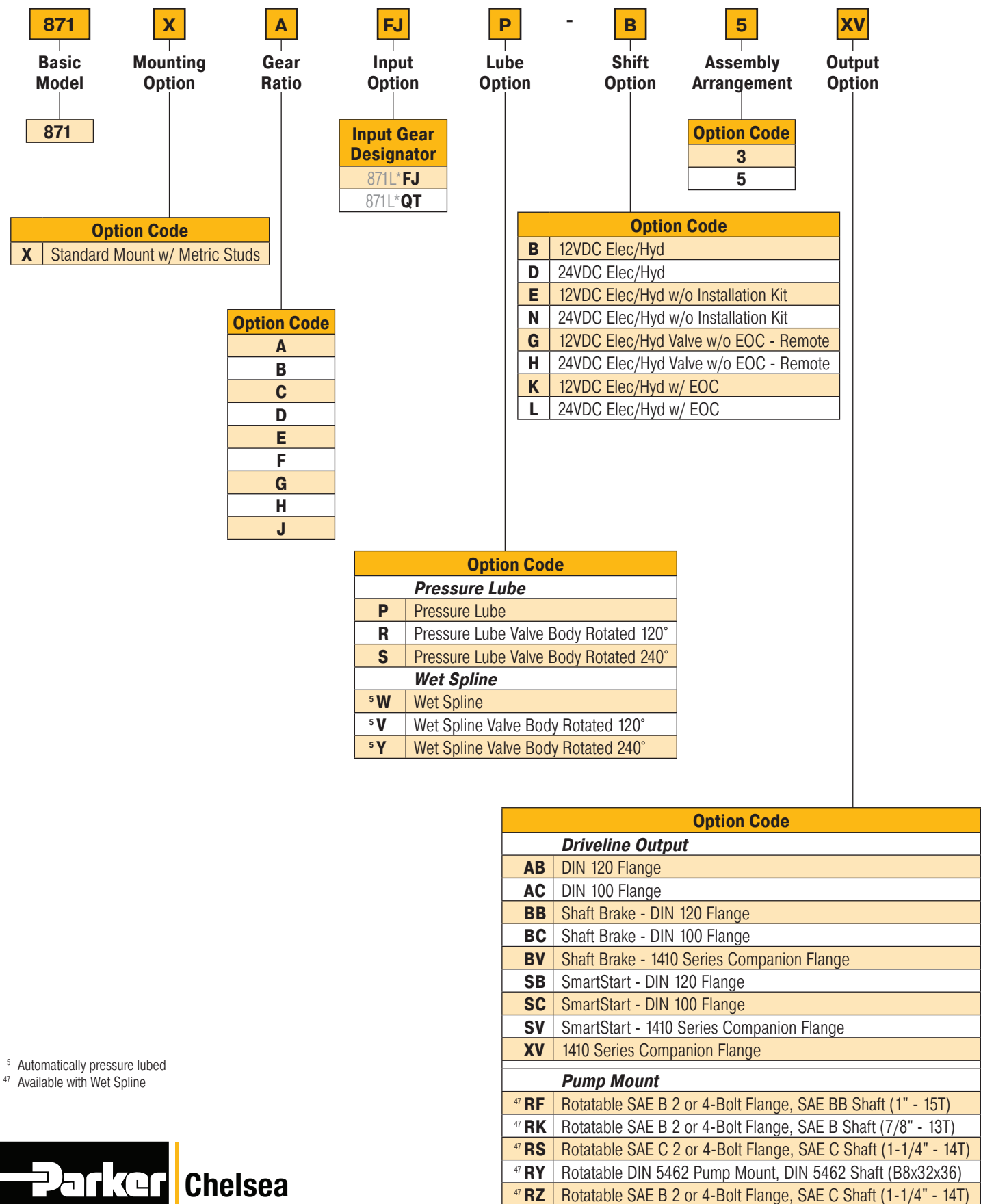

⁵ Automatically pressure lubed

⁴⁷ Available with Wet Spline

871 Series Power Take-Off – Allison
Dimensions & Specifications – For PTO output information see application catalog

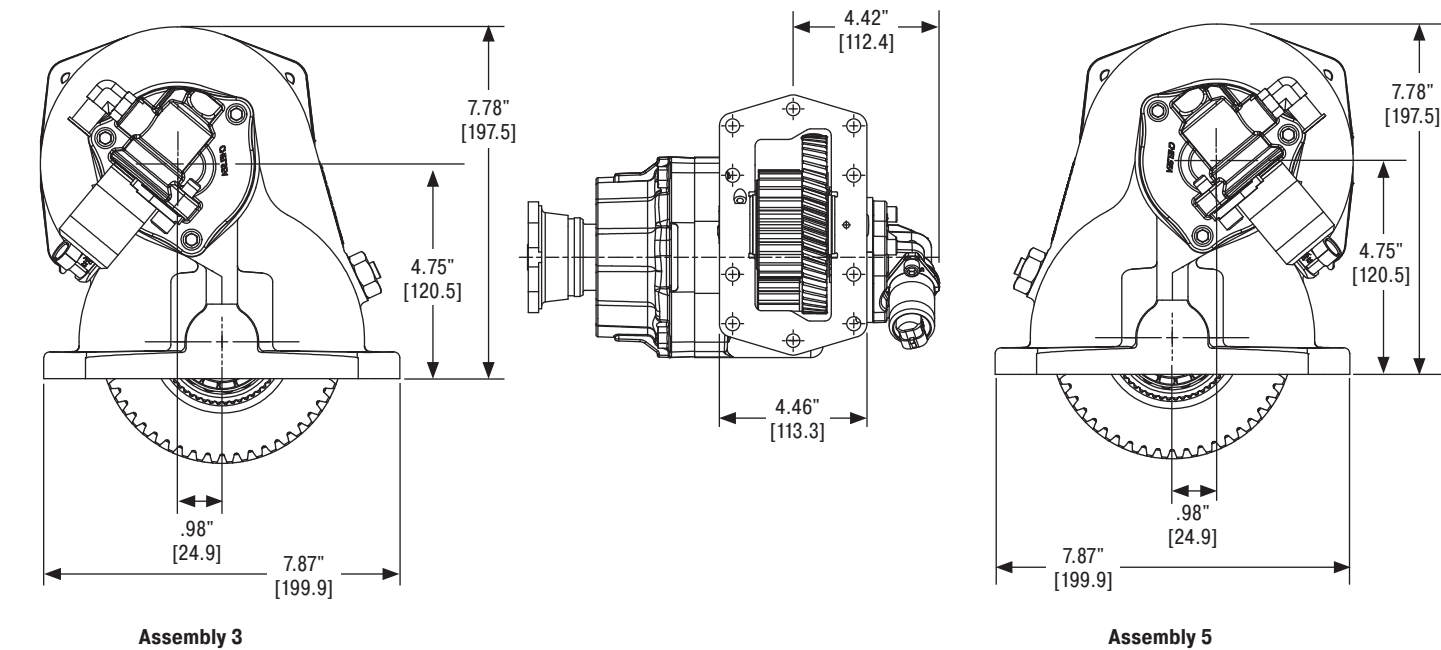

Specifications Chart	Approximate Weight: 57 lbs. [26 kg]								
	871*A	871*B	871*C	871*D	871*E	871*F	871*G	871*H	871*J
Continuous Torque Rating lb-ft [N-m]	670 [909]	630 [854]	590 [800]	550 [746]	485 [658]	430 [583]	380 [515]	355 [481]	335 [454]
HP Rating for Continuous Service									
At 500 RPM of Output Shaft HP [kW]	64 [48]	60 [45]	56 [42]	52 [39]	46 [34]	41 [31]	36 [27]	34 [25]	32 [24]
At 1000 RPM of Output Shaft HP [kW]	128 [95]	120 [89]	112 [84]	105 [78]	92 [69]	82 [61]	72 [54]	68 [50]	64 [48]

Parker Hannifin Corporation
Chelsea Products Division
8225 Hacks Cross Road
Olive Branch, MS 38654 USA
phone 1-888-PH4-TRUK (1-888-744-8785)
chd_support@support.parker.com
www.parker.com/chelsea

HY25-0210-B1/US
November 2025

© 2025 Parker Hannifin Corporation

